

adbri MASONRY

inspired living



Versawall™



The Versawall™ system is a unique interlocking retaining wall system which is perfect for reclaiming sloping land and constructing garden beds and planter boxes. These blocks feature a patent pending design with self locating lugs which makes it quick and easy to build garden walls. The Versawall™ system creates pure vertical retaining walls which means less yard space is required and a modern look is achieved.

FEATURES INCLUDE

- Very quick and easy to build a wall with these self interlocking blocks
- Build up to 800mm high (4 courses) plus the capping unit

COLOUR OPTIONS



Charcoal



Oatmeal



Sunstone

AVAILABLE SIZES

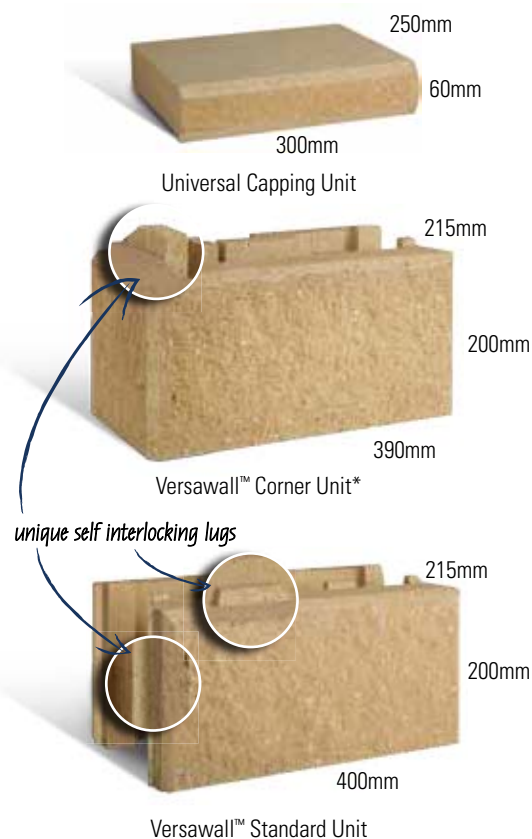

**Versawall® corner units are sold as pairs*





TYPICAL CROSS SECTION OF VERSAWALL™

Versawall™ cross section - Retaining wall

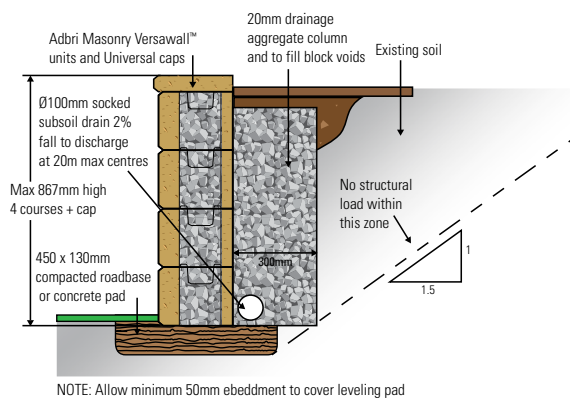

Versawall™ cross section - Raised planter

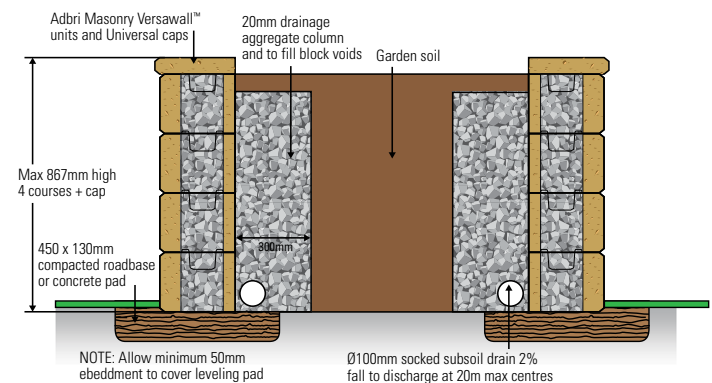

Maximum unreinforced height is 800mm plus the capping unit. This is four courses plus the cap. This wall can be constructed to heights in excess of 800mm when designed by an engineer and reinforced. Check with your local council for any further requirements regarding building retaining walls in your area.

BUILDING STEPS

Versawall™ units can be used to create steps in your backyard. The simplest step design uses standard units with corner units. The Universal cap is then used as the step treads. Alternatively, bullnose pavers can also be used for step treads.

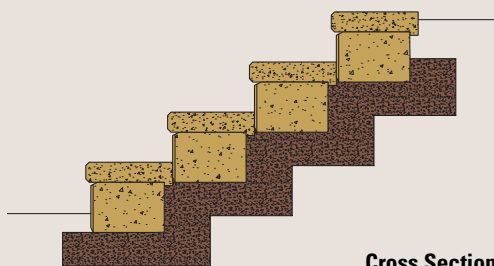

Cross Section

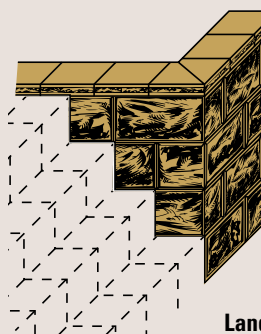

Landscape View

NO FINES CONCRETE (NFC) CROSS SECTION OF VERSAWALL™

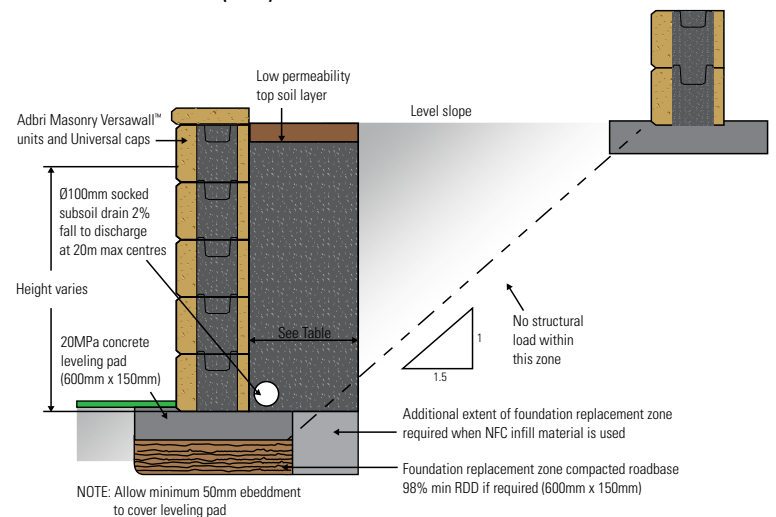

Height (mm)	Infill	Depth (mm)
800	agg	300
1000	NFC*	300
1200	NFC*	350
1400	NFC*	450

Notes

- Where NFC is used as infill material wall must be founded on foundation replacement zone as detailed in cross section
- Where NFC concrete is used remove one wing from each block to allow for sufficient bond to develop between wall units and NFC
- Walls over 800mm will need to be designed from a certified engineer.

LAYING INSTRUCTIONS - How to build your own wall!

Step 1



Step 1 - Dig a shallow trench, level and place 100mm of crushed rock in the bottom. Level and compact. Allow for 50mm embedment of the bottom course and 300mm behind the wall for drainage.

Step 2



Step 2 - Spread and level approximately 25mm of coarse sand as a bedding layer then place the first course of Versawall™ units. Use a stringline for creating a straight line, and level from side to side and front to back. Install a 90mm Agricultural Pipe (on grade) at the rear of the wall for drainage.

Step 3



Step 3 - Fill Versawall™ cores and 300mm behind each course with granular rock for drainage and carefully compact. Check each course is level before proceeding and stacking each additional row offsetting from the block below to maintain half bond.

Step 4



Step 4 - On the last course of stacking units, remove locating lugs on top of the Versawall™ blocks, place a line of adhesive front and back and place the capping unit. Apply pressure to secure and use a stringline and level for the best result. (See Pic 3A and 3B)

Notes - Slope the soil above and below the wall to ensure that water will flow away from and not accumulate near the wall.
- It is advisable to place a dab of adhesive between corner units.

How to build your own internal corner!

Use standard Versawall™ units, remove locating lugs set corner at half bond. Fill cores and 300mm behind each course with granular rock for drainage and carefully compact.



Pic 1A



Pic 1B



Pic 2A



Pic 2B

How to build your own external corner!

Use Versawall™ left and right corner units to construct an external corner.

1. Remove the two lugs from the corner unit prior to installing the following courses.
2. To finish the wall, mitre cut the caps and remove all locating lugs from the top of the block prior to securing capping units.

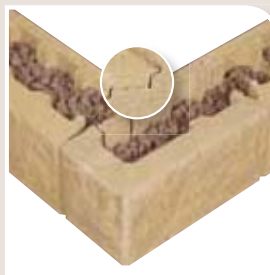

Pic 3B

Even the corner units feature the unique self locating lugs which makes it very easy to create perfect 90 degree external corners.

For more inspirational ideas visit www.adbrimasonry.com.au | 1300 365 565

Versawall™ Brochure
Adbri Masonry Pty Ltd
ABN: 31 009 687 521

Versawall™ and the Adbri Masonry logo are trademarks of Adbri Masonry Pty Ltd.

The Versawall Retaining Wall System is the subject of pending patent applications in Australia and Australian Registered Design No. 334686.

adbriMASONRY
inspired living